

Cabinet Parts Location

Ref. No.	Part No.	Part Name & Description	Remarks	Ref. No.	Part No.	Part Name & Description	Remarks
		CABINET PARTS				PACKING MATERIALS	
1	RHD30007	SCREW		P1	RP61719	PACKING CASE (SYSTEM)	(E) (EG)
2	RKM0202B-1K	CABINET		P1	RP61735	PACKING CASE (SYSTEM)	(EB)
3	XTBS3+8JFZ1	SCREW		P1	RP61740	PACKING CASE (SYSTEM)	(GC)
4	RGW0183-K	KNOB, MAIN VOLUME		P1	RP61757	PACKING CASE (SYSTEM)	(GN)
5	RFKJECH404EK	BOTTOM BOARD ASS'Y	(E) (EB) (EG) (GN)	P2	RP61314	PACKING CASE (CD/TUNER)	
5	RFKJECH404GC	BOTTOM BOARD ASS'Y	(GC)	P3	RP61312	PACKING CASE (AMPLIFIER)	
5-1	RKAO011A-2	FOOT		P4	RP61313	PACKING CASE (DECK)	
6	RFKJECH404EB	REAR GRILL ASS'Y	(EB)	P5	RPN0719	PAD (CD/TUNER)	
6	RFKJECH404EG	REAR GRILL ASS'Y	(EG)	P6	RPN0720	PAD (AMPLIFIER)	
6	RFKJECH404GC	REAR GRILL ASS'Y	(GC)	P7	RPN0721	PAD (DECK)	
6	RFKJECH404GN	REAR GRILL ASS'Y	(GN)	P8	XZB45X50A01Z	PROTECTION COVER	
6	RKF0331-K	REAR GRILL	(E)	P9	RPQ0047	ACCESSORY BOX	
7	RKQ0089	P. C. B. SPACER		P10	RPQ0244	SPACER	
8	RMCO158	TRANSISTOR HOLDER		P11	XZB22X20C03	PROTECTION COVER	
9	RMNO191	HOLDER				ACCESSORIES	
10	RFKJECH404EK	FRONT PANEL ASS'Y	(E) (EB) (EG) (GN)	A1	RAK-CH115WH	REMOTE CONTROL TRANSMITTER	
10	RFKJECH404GC	FRONT PANEL ASS'Y	(GC)	A1-1	RKK0057-K	BATTERY COVER	
11	RGL0210-Q	PANEL LIGHT		A2	REE0499	SPEAKER CORD	
12	RGU0939-K	BUTTON, POWER		A3	REX0511	FLAT CABLE (15P) (BLACK TYPE)	
13	RGW0178-K	KNOB, MIC		A4	REX0512	FLAT CABLE (15P) (WHITE TYPE)	
14	RMNO232	HOLDER		A5	RJA0019-2K	AC POWER SUPPLY CORD	△ (E) (EG) (GC) (SF)
15	XTBS26+8J	SCREW		A5	VJA0733	AC POWER SUPPLY CORD	△ (EB) (SF)
16	XTWS3+10T	SCREW		A5	RJA0036-K	AC POWER SUPPLY CORD	△ (GN)
17	SNE4021-1	NUT		A6	RFKSECH404EK	INSTRUCTIONS MANUAL	(E)
18	XTB3+20JFZ	SCREW		A6	RFKSECH404EB	INSTRUCTIONS MANUAL	(EB)
19	XTB3+8JFZ	SCREW		A6	RFKSECH404EG	INSTRUCTIONS MANUAL	(EG)
20	XTW3+15T	SCREW		A6	RQT2108-G	INSTRUCTIONS MANUAL	(GC)
21	XTW3+8T	SCREW		A6	RFKSECH404GN	INSTRUCTIONS MANUAL	(GN)
22	REZ0538	FLAT CABLE (J703)	(GC)	A7	RQA0013	WARRANTY CARD	(E) (EB) (EG)
22	REZ0606	FLAT CABLE (W703)	(E) (EB) (EG) (GN)	A7	RQX7433ZA	WARRANTY CARD	(GN)
23	RMNO190	P. C. B. SPACER	(GC)	A8	RQCB0169	SERVICE CENTER LIST	
24	RMNO215	FAN ANGLE	(GC) (GN)	A9	RSA0007	FM INDOOR ANTENNA	(E) (EB) (EG)
25	SYE1128-4	FAN ASS'Y	(GC) (GN)	A9	RSA0006	FM INDOOR ANTENNA	(GC) (GN)
25-1	SHE232	FAN	(GC) (GN)	A10	SPB1163T	AM LOOP ANTENNA	(E) (EB) (EG) (GN)
25-2	SUS271	SPRING	(GC) (GN)	A10	RSA0010	AM LOOP ANTENNA	(GC)
25-3	SHE233-1	FAN CASE	(GC) (GN)	A10-1	SMA233-1M	ANTENNA HOLDER	(E) (EB) (EG) (GN)
25-4	MDN-4RB4MRC	MOTOR	(GC) (GN)	A10-1	RMNO244	ANTENNA HOLDER	(GC)
25-5	SHE234	CAP	(GC) (GN)	A10-2	XTN3+10AFZ	SCREW	(E) (EB) (EG) (GN)
25-6	SJT783	TERMINAL	(GC) (GN)	A10-2	XTN3+12AFZ	SCREW	(GC)
25-7	SJS5215	CONNECTOR (2P)	(GC) (GN)	A11	SJP9009	ATTACHMENT PLUG	△ (EB)
26	XTB3+12JFZ	SCREW	(GC)	A12	SJP5213-2	POWER PLUG ADAPTOR	△ (GC)
27	REZ0608	FLAT CABLE (W501)					
28	RHD30032	SCREW	(E) (EB) (EG) (GN)				

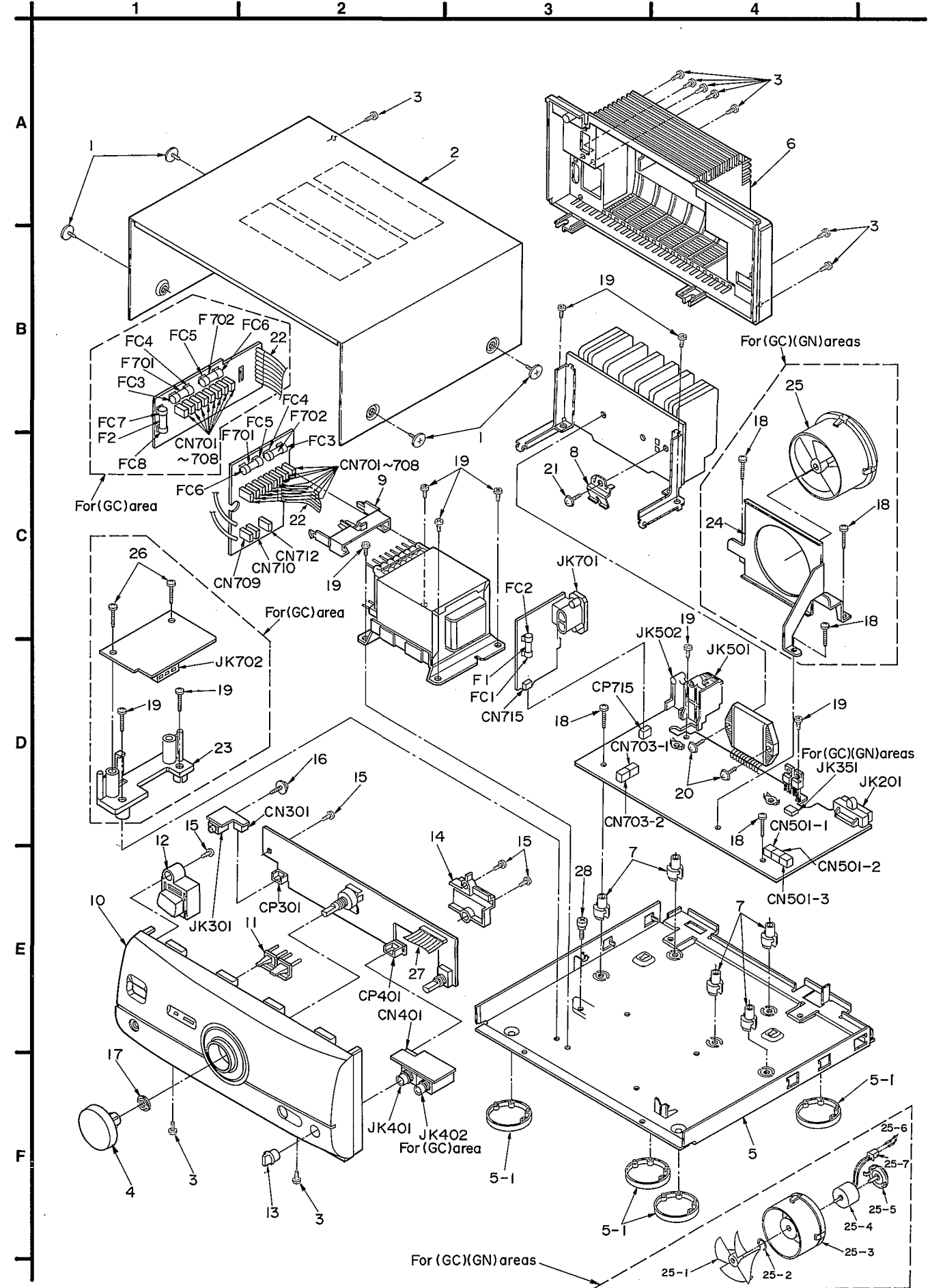

■ Packaging

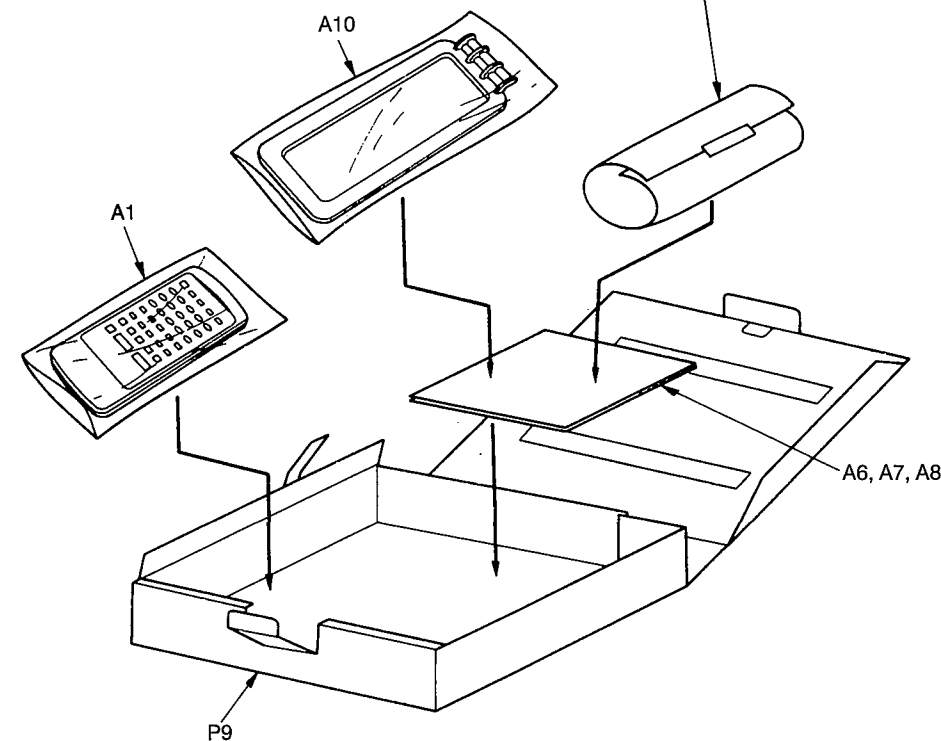
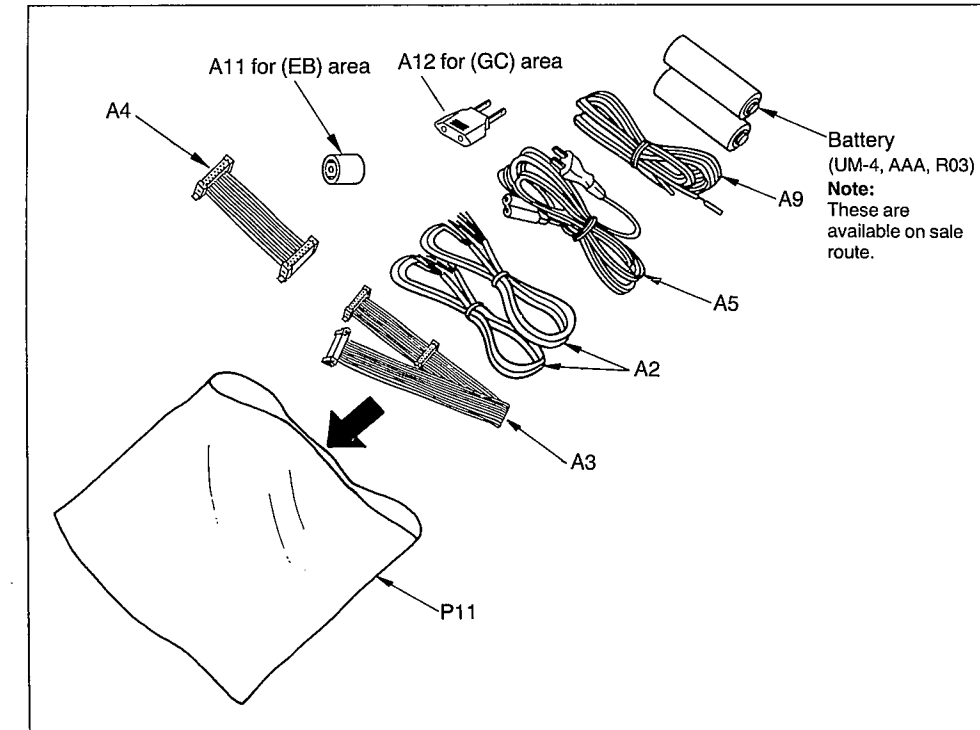
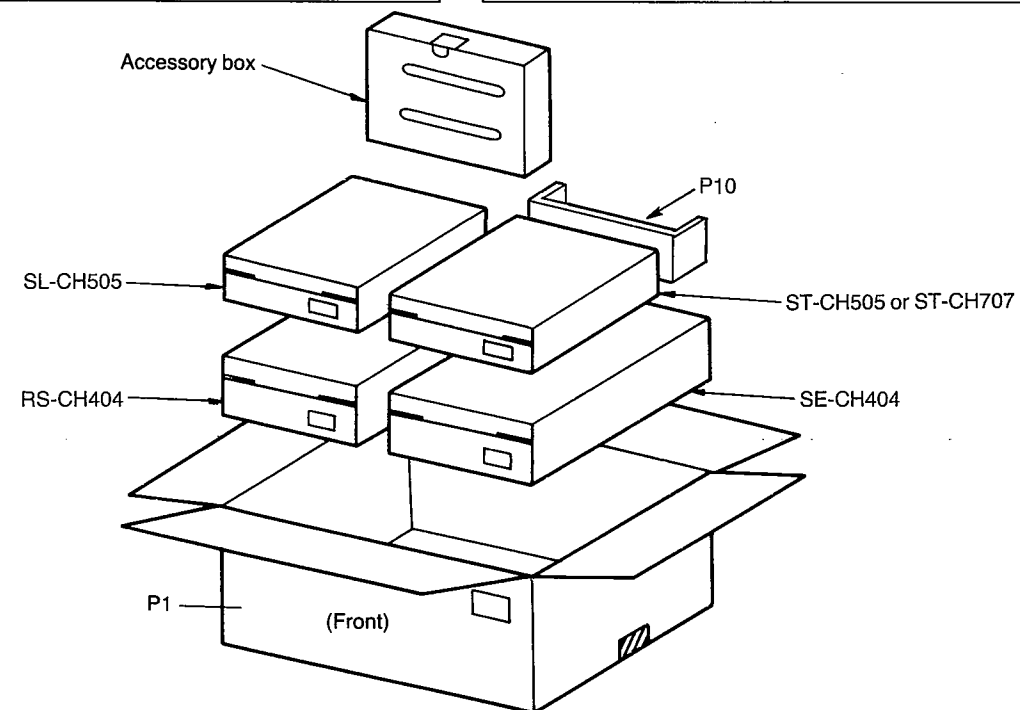
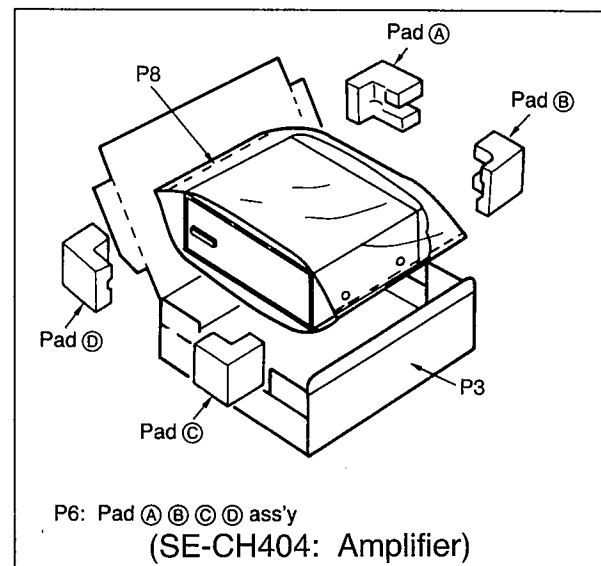
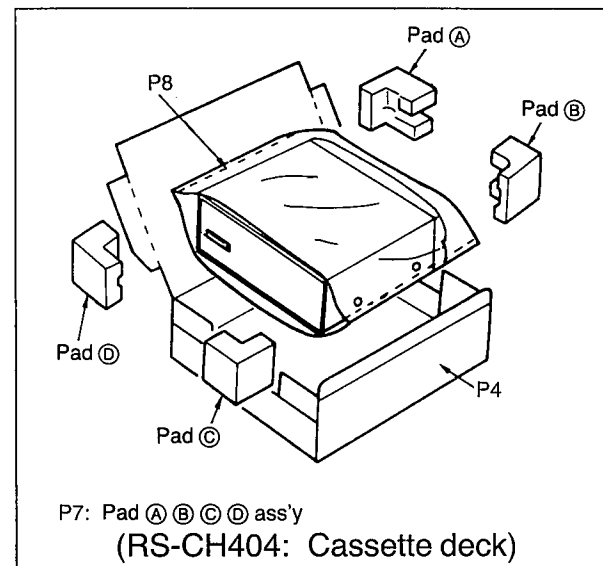
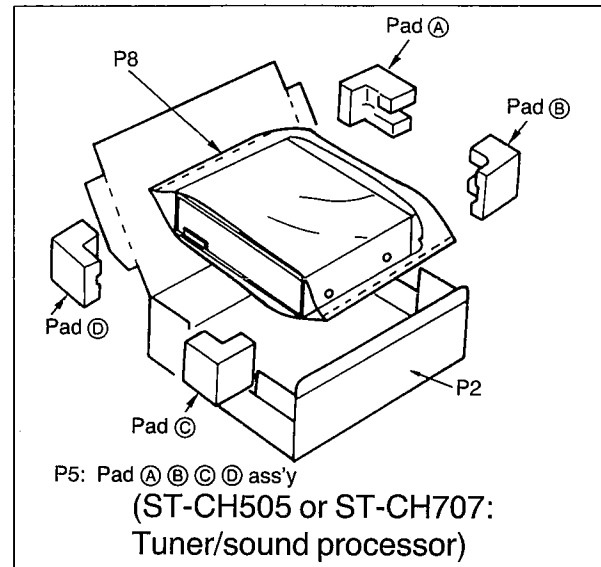
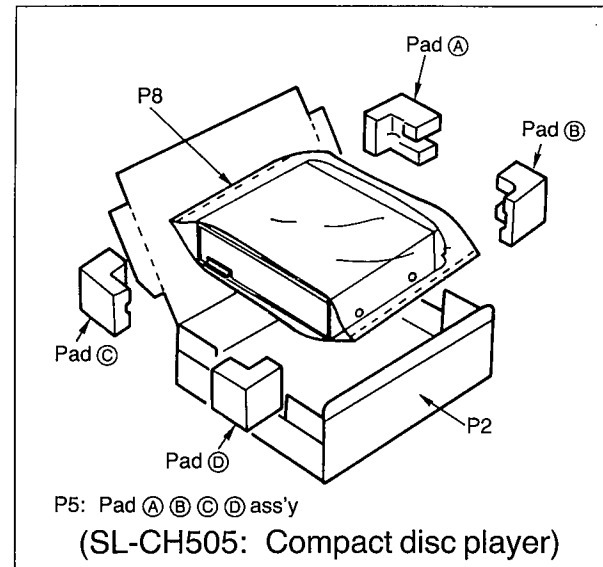

■ Replacement Parts List

Notes: *Important safety notice:
Components identified by Δ mark have special characteristics important for safety.
Furthermore, special parts which have purposes of fire-retardant (resistors), high-quality sound (capacitors), low-noise (resistors), etc. are used.
When replacing any of components, be sure to use only manufacturer's specified parts shown in the parts list.
*The parenthesized indications in the Remarks columns specify the areas. (Refer to the cover page for area.)
Parts without these indications can be used for all areas.
*Remote Control Ass'y: Supply period for three years from termination of production.
*The "(SF)" mark denotes the standard part.

Ref. No.	Part No.	Part Name & Description	Remarks	Ref. No.	Part No.	Part Name & Description	Remarks
		INTEGRATED CIRCUIT(S)		L701	RLQZ271M	COIL	Δ (EG)
						FUSE(S)	
IC301	M5218AP	I. C. HEADPHONES AMP.		F1	XBA2C10TB0	FUSE, 250V T1. 0A	Δ (E) (EB) (EG)
IC351	M5218AP	I. C. SIGNAL LEVEL DET	(GC) (GN)	F1	XBA2C25TB0	FUSE, 250V T2. 5A	Δ (GC)
IC401	AN6558-FSG	I. C. MIC AMP.		F1	XBA2C12TB0	FUSE, 250V T1. 25A	Δ (GN)
IC501	SV13101D	I. C. POWER AMP.	Δ (E) (EB) (EG)	F2	XBA2C12TB0	FUSE, 250V T1. 25A	Δ (GC)
IC501	SV13102D	I. C. POWER AMP.	Δ (GC) (GN)	F701, 702	XBA2C16TB0	FUSE, 250V T1. 6A	Δ
		TRANSISTOR(S)				SWITCH(ES)	
Q201, 202	2SD1450RTA	TRANSISTOR		S601	EVQ21405R	SW. POWER	
Q203	UN4115	TRANSISTOR		S701	ESE37263	SW. VOLTAGE ADJ	Δ (GC)
Q352	KSD471ACYGTA	TRANSISTOR	Δ (GC) (GN)			CONNECTOR(S)	
Q354	2SC3311ARSTA	TRANSISTOR		J704B	RJU057W004	SOCKET(4P)	(GC)
Q361	KSD471ACYGTA	TRANSISTOR	Δ (GC) (GN)	CN301	RJU057W004	SOCKET(4P)	
Q362	2SC3327-A	TRANSISTOR	Δ (GC) (GN)	CN401	RJU057W004	SOCKET(4P)	
Q371	2SC3311ARSTA	TRANSISTOR	(GC) (GN)	CN701-708	RJSLA1101T1	SOCKET(1P)	
Q571, 572	2SC3311ARSTA	TRANSISTOR		CN709, 710	RJSLA1101T1	SOCKET(1P)	(E) (EB) (EG) (GN)
Q573	2SA1309ARSTA	TRANSISTOR		CN712	RJSLA1101T1	SOCKET(1P)	(E) (EB) (EG) (GN)
Q591, 592	2SC3312RSTA	TRANSISTOR		CN715	RJU057W004	SOCKET(4P)	(E) (EB) (EG) (GN)
Q601	UN4211	TRANSISTOR		CN501-1-3	RJSLA6604	SOCKET(4P)	
Q701	2SD1762EF	TRANSISTOR	Δ	CN703-1, 2	RJSLA6604	SOCKET(4P)	
Q702	2SB1185EF	TRANSISTOR	Δ	CP301	RJT057W004-1	CONNECTOR(4P)	
Q704	2SC3112TA	TRANSISTOR		CP401	RJT057W004-1	CONNECTOR(4P)	
		DIODE(S)		CP715	RJT057W004-1	CONNECTOR(4P)	
D351	MA165	DIODE	(GC) (GN)			EARTH TERMINAL(S)	
D352	MA4068M	DIODE	Δ (GC) (GN)	E501	SNE1004-1	GND PLATE	
D361	MA4091-M	DIODE	Δ (GC) (GN)	E701	SNE1004-1	GND PLATE	
D362	MA165	DIODE	(GC) (GN)			FUSE HOLDER(S)	
D371	MA165	DIODE	(GC) (GN)	FC1-6	EYF52BC	FUSE HOLDER	
D401	MA4062MTA	DIODE		FC7, 8	EYF52BC	FUSE HOLDER	(GC)
D601	SLR-305MC	DIODE LED				TRANSFORMER(S)	
D602	SLR-305VC	DIODE LED		PT701	RTP2M5B002	POWER TRANSFORMER	Δ (E) (EB) (EG)
D611	MA4075MTA	DIODE	Δ	PT701	RTP2M5G002	POWER TRANSFORMER	Δ (GC)
D701-704	P300DLF	DIODE	Δ	PT701	RTP2M5B003	POWER TRANSFORMER	Δ (GN)
D705, 706	RL1M4003W02	DIODE	Δ			RELAY	
D712	MA4240H	DIODE		RL701	RSY0013M-0	RELAY	Δ
D715, 716	MA4150M	DIODE	Δ			JACK(S)	
D754	MA4051MTA	DIODE	Δ			CONNECTOR(15P)	
		VARIABLE RESISTOR(S)				HEADPHONES JACK	
VR401	EVJ02BF02B14	V. R. MIC VOLUME CONTROL					
VR601	EVQWQAF2524B	V. R. MAIN VOLUME CONTROL					
		COIL(S)					
L501, 502	SLQY07G-40	COIL					

Ref. No.	Part No.	Part Name & Description	Remarks				
JK351	SJT3213	CONNECTOR (2P)	(GC) (GN)				
JK401	RJTG5MA01	MIC JACK					
JK402	RJTG5MA01	MIC JACK	(GC)				
JK501	RJR0054M	SPEAKER TERMINAL					
JK502	SJF3068-6N	SPEAKER TERMINAL (SURROUND)					
JK701	SJS9236	AC INLET	Δ (E) (EB) (EG) (GC)				
JK701	SJSD16	AC INLET	Δ (GN)				
JK702	SJS702-1	CONNECTOR	(GC)				

Notes : * Capacity values are in microfarads (μF) unless specified otherwise, P=Pico-farads (pF) F=Farads (F)
* Resistance values are in ohms, unless specified otherwise, 1K=1,000 (OHM) , 1M=1,000k (OHM)

Ref. No.	Part No.	Values & Remarks	Ref. No.	Part No.	Values & Remarks	Ref. No.	Part No.	Values & Remarks
		RESISTORS	R372	ERDS2TJ273	1/4W 27K (GC) (GN)	R509, 510	ERDS2TJ102	1/4W 1K
			R373	ERDS2TJ222	1/4W 2. 2K (GC) (GN)	R511	ERDS2TJ334	1/4W 330K
			R374	ERDS2TJ273	1/4W 27K (GC) (GN)	R512	ERDS2TJ154	1/4W 150K
R159	ERDS2TJ100	1/4W 10	R375	ERDS2TJ822	1/4W 8. 2K	R513	ERDS2TJ684	1/4W 680K
R217, 218	ERDS2TJ102	1/4W 1K	R398	ERDS2TJ332	1/4W 3. 3K (GC) (GN)	R514	ERD25FJ470	1/4W 47 Δ
R223, 224	ERDS2TJ122	1/4W 1. 2K	R399	ERDS2TJ154	1/4W 150K (GC) (GN)	R515, 516	ERDS1FVJ100T	1/2W 10 Δ
R251	ERDS2TJ222	1/4W 2. 2K	R401	ERDS2TJ122	1/4W 1. 2K	R517, 518	ERD25FVJ100T	1/4W 10 Δ
R253, 254	ERDS2EJ121	1/4W 120			(E) (EB) (EG) (GN)	R571	ERDS2TJ823T	1/4W 82K
R255	ERDS2TJ154	1/4W 150K	R401	ERDS2TJ123	1/4W 12K (GC)	R572	ERDS2TJ124T	1/4W 120K
R256	ERDS2TJ105T	1/4W 1M	R402	ERDS2TJ123	1/4W 12K (GC)	R573	ERDS2TJ563	1/4W 56K
R259	ERDS2TJ561	1/4W 560	R403	ERDS2TJ473	1/4W 47K	R574	ERDS2TJ564	1/4W 560K
R291, 292	ERDS2TJ104	1/4W 100K	R404	ERDS2TJ123	1/4W 12K	R575	ERDS2TJ223	1/4W 22K
R301, 302	ERDS2TJ223	1/4W 22K			(E) (EB) (EG) (GN)	R591, 592	ERDS2TJ561	1/4W 560
R303, 304	ERDS2TJ333	1/4W 33K	R404	ERDS2TJ122	1/4W 1. 2K (GC)			(E) (EB) (EG)
R305, 306	ERDS2TJ223	1/4W 22K	R405	ERDS2TJ474	1/4W 470K	R591, 592	ERDS2TJ391	1/4W 390 (GC) (GN)
R307, 308	ERDS2TJ102	1/4W 1K	R406	ERDS2TJ102	1/4W 1K	R593, 594	ERDS2TJ182	1/4W 1. 8K
R309-312	ERDS2EJ121	1/4W 120	R407	ERDS2TJ104	1/4W 100K	R595, 596	ERDS2TJ473	1/4W 47K
R351	ERDS2TJ563	1/4W 56K (GC) (GN)	R408	ERDS2TJ473	1/4W 47K	R597, 598	ERDS2TJ123	1/4W 12K
R352	ERDS2TJ184T	1/4W 180K (GC) (GN)	R409	ERDS2TJ332	1/4W 3. 3K	R601	ERDS2TJ331	1/4W 330
R353	ERDS2TJ474	1/4W 470K (GC) (GN)	R410	ERDS2TJ102	1/4W 1K	R602	ERDS2TJ391	1/4W 390
R354	ERDS2TJ102	1/4W 1K (GC) (GN)	R411	ERDS2TJ562	1/4W 5. 6K	R701, 702	ERD25FJ2R2	1/4W 2. 2 Δ
R355	ERDS2TJ103	1/4W 10K (GC) (GN)	R412	ERDS2TJ102	1/4W 1K	R703, 704	ERDS2TJ562	1/4W 5. 6K
R356	ERDS2TJ332	1/4W 3. 3K (GC) (GN)	R420	ERDS2TJ104	1/4W 100K	R705	ERGISJ182E	1W 1. 8K
R357	ERGISJ390E	1W 39 (GC) (GN)	R501, 502	ERDS2TJ102	1/4W 1K			(E) (EB) (EG)
R358	ERDS1FVJ220T	1/2W 22 Δ (GC) (GN)	R503-506	ERDS2TJ563	1/4W 56K	R705	ERGISJ222E	1W 2. 2K (GC) (GN)
R361	ERDS2TJ474	1/4W 470K (GC) (GN)	R507, 508	ERDS2TJ182	1/4W 1. 8K	R709	ERDS1FVJ221T	1/2W 220 Δ
R362	ERDS2TJ102	1/4W 1K (GC) (GN)			(E) (EB) (EG)			(E) (EB) (EG)
R371	ERDS2TJ103	1/4W 10K (GC) (GN)	R507, 508	ERDS2TJ102	1/4W 1K (GC) (GN)	R709	ERGISJ391E	1W 390 Δ (GC) (GN)

Ref. No.	Part No.	Values & Remarks	Ref. No.	Part No.	Values & Remarks			
R711	ERDS1FVJ221T	1/2W 220 Δ	C599	ECBT1C103MS5	16V 0. 01μ			
		(E) (EB) (EG)	C701, 702	ECEA1HJ222B	50V 2200μ Δ			
R711	ERGISJ331E	1W 330 Δ (GC) (GN)			(E) (EB) (EG)			
R716	ERDS2TJ393	1/4W 39K	C701, 702	ECA1HM332B	50V 3300μ (GC) (GN)			
R717	ERDS2TJ473	1/4W 47K	C703, 704	ECEA1CKA330B	16V 33μ			
R780	ERDS2TJ822	1/4W 8. 2K	C705, 706	ECKR1H103ZF5	50V 0. 01μ			
		CAPACITORS	C707	ECA1HM221B	50V 220μ Δ			
			C711	ECQF1104KF3	100V 0. 1μ			
C251	ECEA0JKA221B	6. 3V 220μ	C712	ECBT1E223ZF	25V 0. 022μ			
C301, 302	ECEA1HKA3R3B	50V 3. 3μ	C714	ECKR1H103ZF5	50V 0. 01μ			
C303, 304	ECBT1H150J5	50V 15P	C731, 732	ECKT1H102KB	50V 1000P			
C305, 306	ECBT1H330J5	50V 33P	C905, 906	ECBT1H101KB5	50V 100P			
C307, 308	ECEA1CKA220B	16V 22μ	C1101, 1102	ECBT1E223ZF	25V 0. 022μ			
C351	ECEA1CKA100B	16V 10μ (GC) (GN)	C1103-1106	ECBT1H102KB5	50V 1000P			
C352	ECBT1E223ZF5	25V 0. 022μ (GC) (GN)						
C353	ECEA1HKA2R2B	50V 2. 2μ (GC) (GN)						
C361	ECEA1CM470SB	16V 47μ (GC) (GN)						
C362	ECBT1H104ZF5	50V 0. 1μ (GC) (GN)						
C371	ECEA0JKA221B	6. 3V 220μ (GC) (GN)						
C381, 382	ECBT1E103ZF	25V 0. 01μ						
C395-398	ECBT1E103ZF	25V 0. 01μ						
C401	ECBT1H221KB5	50V 220P						
C402	ECBT1H221KB5	50V 220P (GC)						
C403	ECEA1HKA3R3B	50V 3. 3μ						
C404, 405	ECBT1H221KB5	50V 220P						
C406	ECEA1CKA100B	16V 10μ						
C407	ECEA1HKA3R3B	50V 3. 3μ						
C408	ECBT1H181KB5	50V 180P						
C409	ECEA1CKA100B	16V 10μ						
C410	ECBT1H221KB5	50V 220P						
C411	ECBT1E103ZF	25V 0. 01μ						
C412	ECBT1E223ZF	25V 0. 022μ						
C414	ECA1AM331B	10V 330μ						
C415	ECBT1H102KB5	50V 1000P						
C421	ECBT1H102KB5	50V 1000P						
C501, 502	ECA1HAP3R3B	50V 3. 3μ						
C503, 504	ECBT1H331KB5	50V 330P						
C505, 506	ECBT1H150J5	50V 15P						
C507, 508	ECBT1C152KR5	16V 1500P						
		(E) (EB) (EG)						
C507, 508	ECBT1C272KR5	16V 2700P (GC) (GN)						
C509, 510	ECEA1HK010B	50V 1μ						
		(E) (EB) (EG)						
C509, 510	ECEA1HKA2R2B	50V 2. 2μ (GC) (GN)						
C511, 512	ECBT1H821KB5	50V 820P						
C513	ECA1HAP330B	50V 33μ						
C514	ECA2AAP100B	100V 10μ						
C515, 516	ECBT1H104ZF5	50V 0. 1μ						
C571	ECEA0JKA101B	6. 3V 100μ						
C572	ECBT1E223ZF	25V 0. 022μ						
C591, 592	ECEA1HK010B	50V 1μ						
C593, 594	ECQV1H104JM3	50V 0. 1μ						